

54x30mm 90 Degree Joiner for Glass Balustrade / Pool Fence Top Rail



DIYGLASS
www.diyglass.com.au

54x30mm 90 Degree Joiner for Glass Top Rail



DIYGLASS
www.diyglass.com.au

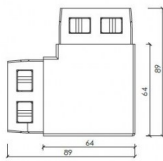

- Joins 54x30mm Slotted Tube at a 90 degree angle (on a corner)
- Use for Glass Balustrade or Glass Pool Fence Top Rail
- 316 grade Stainless Steel
- Fit by Welding or epoxy glue
- Available in Mirror or satin finish

Rating: Not Rated Yet

Price
\$ 27.55

\$ 2.50

[Ask a question about this product](#)

Description

- Joins 54x30mm Slotted Tube at a 90 degree angle (on a corner)
- Use for Glass Balustrade or Glass Pool Fence Top Rail
- 316 grade Stainless Steel
- Fit by Welding or epoxy glue
- Available in Mirror or satin finish

// //