

25x21mm Extended Wall Plate for Glass Balustrade / Pool Fence Top Rail



DIYGLASS
www.diyglass.com.au

25x21mm Tube Extended Wall Bracket



DIYGLASS
www.diyglass.com.au

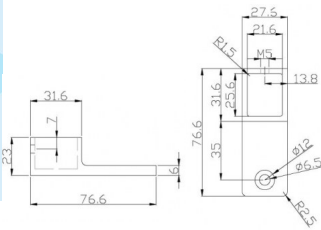

- Extended Wall Plate for use with Face Mount Glass Balustrade
- Used to attach rail to flat post or wall
- Use for Glass Balustrade or Glass Pool Fence Top Rail
- 316 grade Stainless Steel
- Fit by Welding or epoxy glue
- Available in Mirror or satin finish

Rating: Not Rated Yet

Price
\$ 19.85

\$ 1.80

[Ask a question about this product](#)

Description

- Extended Wall Plate for use with Face Mount Glass Balustrade
- Used to attach rail to flat post or wall
- Use for Glass Balustrade or Glass Pool Fence Top Rail
- 316 grade Stainless Steel
- Fit by Welding or epoxy glue
- Available in Mirror or satin finish

// //